



**EMS Brno**

**Data Acquisition Environment**

Hardware – Software – Cloud application

[www.emsbrno.cz](http://www.emsbrno.cz)

## Precipitation gauge maintenance

Due to vulnerability (moving mechanical parts) and irreplaceability of measured data (spatial heterogeneity), cleanliness is crucial not only in terms of accuracy but also reliability. Especially in dusty environments, muddy deposits form on the calibrated container, which fundamentally affect the function of the rain gauge. Bird excrement is a serious problem, so we recommend to use bird protection. For rain gauges located close to the ground, care must be taken to ensure that the mechanism is not clogged with mud!

During periodical inspection and maintenance, it is necessary to focus on:

- **cleaning the collecting funnel and sieve**
  - the sieve needs to be removed and cleaned
  - remove any dirt at the bottom of the funnel



- **cleaning the rain gauge spoon**
  - the spoon must be fixed so that no false precipitation record is created during cleaning

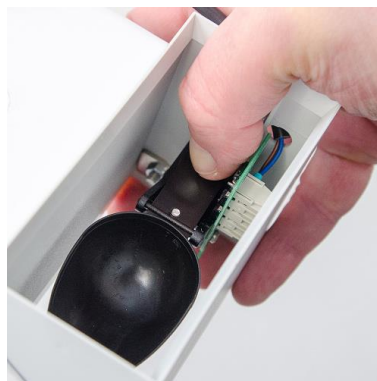

- **removing dirt from the rain gauge container**
  - the bottom lid is removable
  - check the permeability of the drain holes
  - the container must also be cleaned of cobwebs, cocoons, or mud and other impurities



***the new versions are supplied equipped with a net drawer that can simply slides out for cleaning:***



After cleaning, put the funnel on and insert the sieve.  
Check the horizontality of the rain gauge, resp. verticality of the support pin.